

“SNVL2014” safety lamp



Sultan s.r.l.
Via Pedret 18
34076 Romans d'Isonzo (Go) – Italy
fax/phone number: +39 0481 950333
e-mail: info@sultansrl.it
www.sultansrl.it

Installation and use instructions

SNVL2014 is a high efficiency and quality lamp for the safety lighting in private civil environments, naval and hotel environments.

PRODUCT DESCRIPTION:

<i>Light source:</i>	white LED
<i>Mains:</i>	220 V / 50-60 Hz
<i>Autonomy:</i>	4-5 hours
<i>Full battery recharge:</i>	14 hours
<i>Body compatibility:</i>	Vimar Idea
<i>Automatic circuit start-up begins at the supply.</i>	
<i>Automatic switch-off with dead battery.</i>	



SAFETY:

SNVL2014 is intrinsically safe, however it's necessary to keep and follow these instructions in every situation:

- The installation must be carried out only after the **safe** sectioning of the mains.
- Keep the lamp away from fire: the internal Ni-MH may explode.
- Dispose of SNVL2014 according with the law in force.

INSTALLATION:

1) Clear the mains by means of the main switch (it must be locked in "open" position).

2) Remove the protective case (pic. 2).

3) **Insert the supplied electrical bridge** in the two terminals on top of the battery (near the sign +).

This should be done only once and is used to connect the battery to avoid draining it completely during transport and storage (pic. 3)

4) Reinsert the protective case.

5) Insert SNVL2014 in the support until the "click" sound is heard (pic. 5).

6) Connect the wires directly to the mains.

7) Position the support and the frame (pic. 7).

8) Act on the main switch to reactivate the mains.

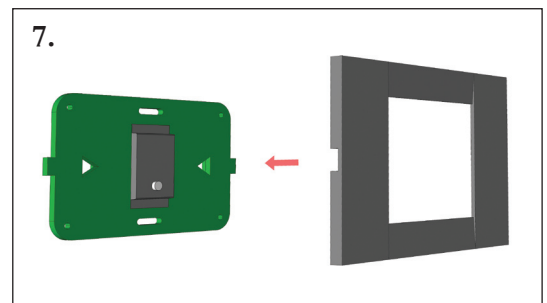
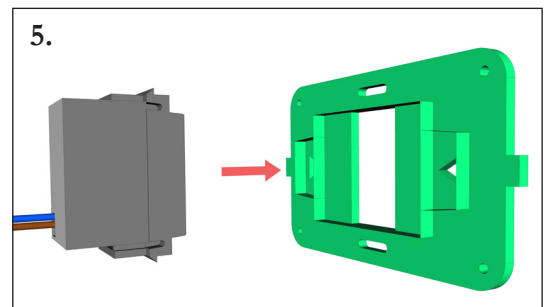
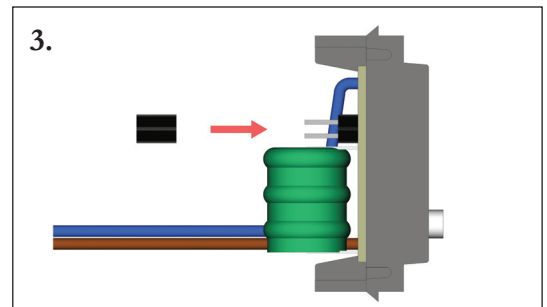
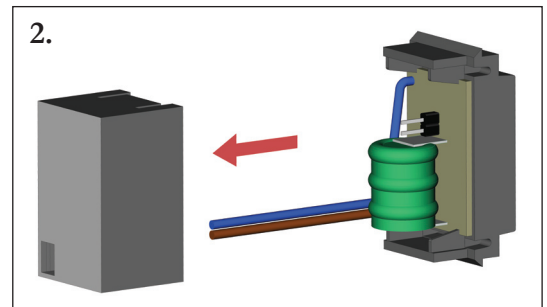

FUNCTIONING:

At the presence of the mains, the internal battery is in charge. SNVL2014 is ready to be used when the charging is over. When the mains fails, the white LED lights. When the mains returns, the white LED switches off and the battery is recharged.

CHECKS:

SNVL2014 does not require any maintenance.

Yearly or when advisable clear the mains, check the life of the lighting until the complete discharge, then feed again.